

# Tuya Smart (Smart Home Control App)

- Full control of your smart home devices
- Customize lighting, door sensors, sos button, smart intercom, and more directly from the mirror.

## 1. Download the Tuya Application

Go to Tuya > Click “+” at home page > Add devices

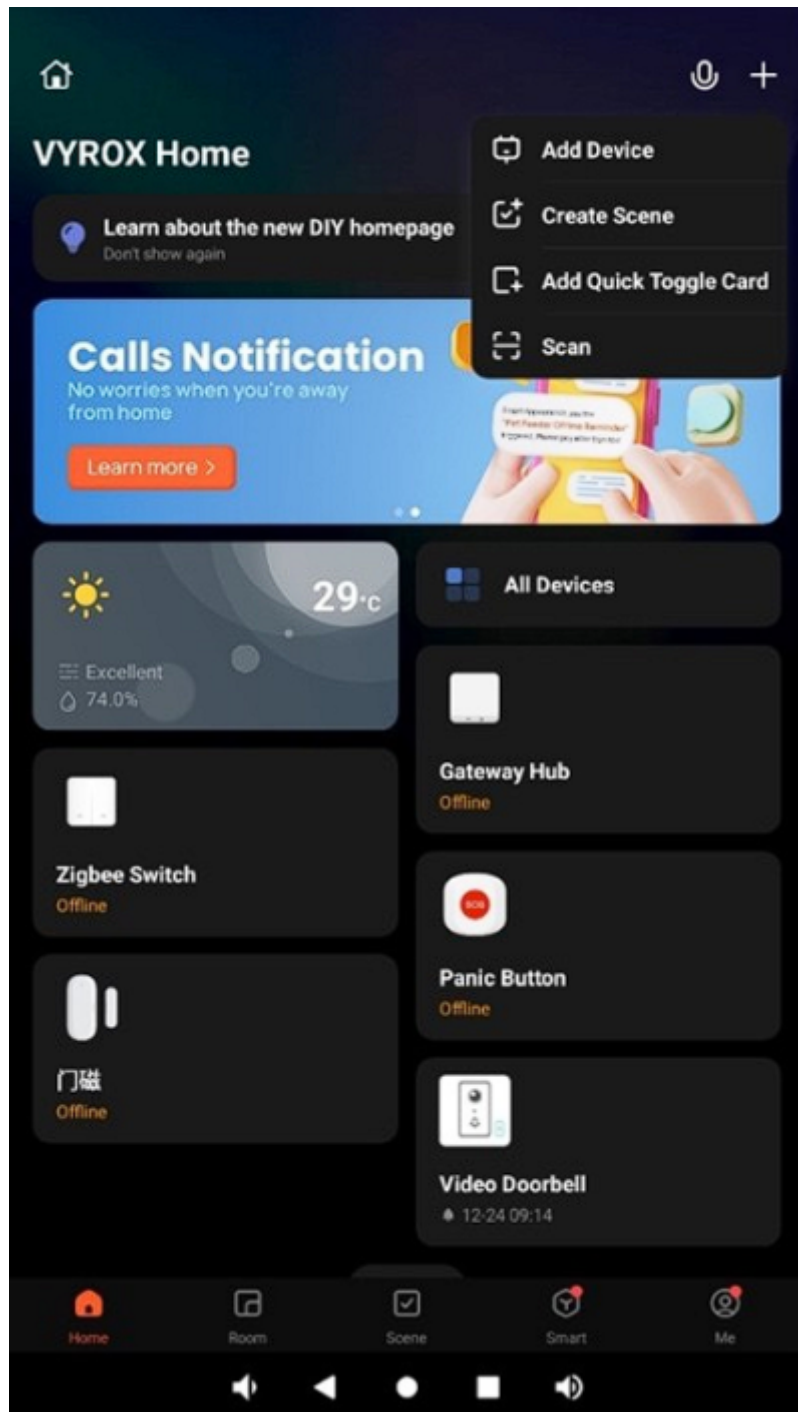

## 2. Register Account

## Download App and Register Account



**Tuya Smart** (4.4)  
Smart Life Smart Living  
Tuya Smart Inc.  
#56 in Utilities  
★★★★★ 4.7 • 43.3K Ratings  
Free • Offers In-App Purchases

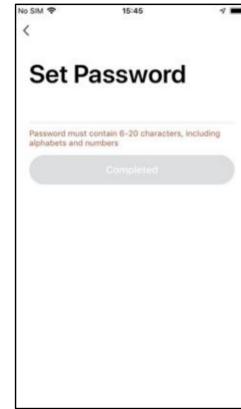
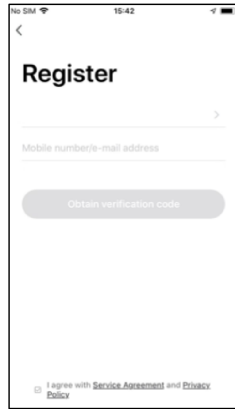

### Step 1: Sign In

Search and download “Tuya Smart” in major application markets or scan the QR code below to download the App.

### Step 2: Register with Your Gmail Account

Enter your Gmail and verification code to verify your system account.

**Note: Must use Gmail in order to activate voice control command.**

### Step 3: Enter Password

Then, enter password and click “completed” to complete registration.

## 3. Create Houses



## Create Houses

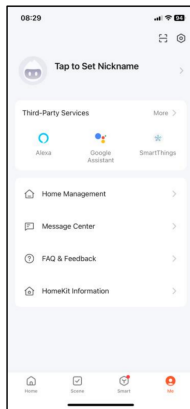

### Step 1: Go to “Me”

Click “Home Management”.

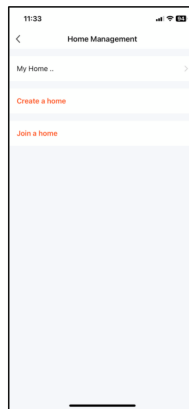

### Step 2: Click “My Home ...”

Click “My Home ...”, enter home name, enter location and add area for your home. If you have more than 1 house, click “Create a home” for your next house.

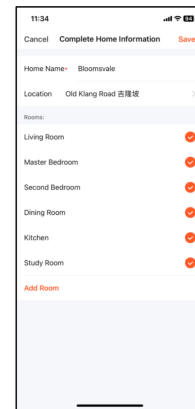

### Step 3: Create room

Enter home name, enter location and click “Add Room” for additional room or area.

## 4. Add Family Members

## Add Family Members

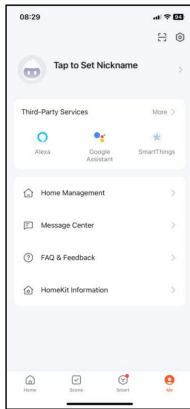

**Step 1: Go to "Me"**  
Click "Home Management".

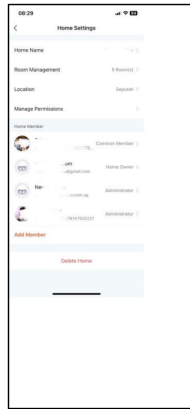

**Step 2: Add Member**  
Click "Add Member" to invite other family members to join this house.

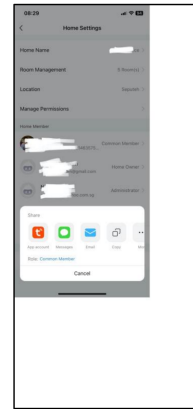

**Step 3: Share**  
Fill in appointment date, visitor name, mobile

## 5. Add Device: Zigbee Gateway

### Add Device: Zigbee Gateway



**Step 1: Get ready Zigbee Gateway**  
Plug in a Zigbee gateway and connect network cable to the router.



**Step 2: Connect Smart Phone with Home Router WiFi**  
Make sure your gateway and smart phone under same local network.

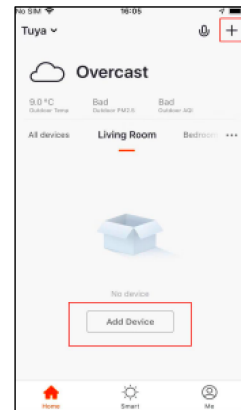

**Step 3: Click "+" at right top corner**  
Click "Add Device"

## Add Device: Zigbee Gateway

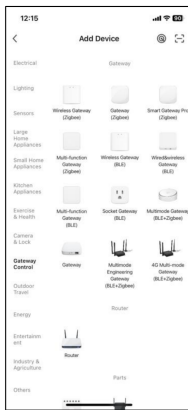

**Step 4: Add Gateway Control**  
Select "Gateway Control" > "Gateway (Zigbee)".



**Step 5: Follow Instruction in APP**  
Click "Confirm the indicator is blinking".



**Step 6: Connecting Device**  
You are connecting to the gateway. Repeat the step 4 to Step 5 if you cannot connect the device until it is successfully connected.

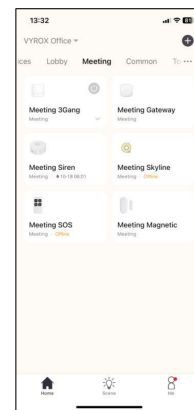

**Step 7: Gateway is connected.**  
When gateway have been configured successfully, gateway will appear on the home page.

## 6. Add Lighting Control Switch into Zigbee Gateway

### Add Lighting Control Switch into Zigbee Gateway

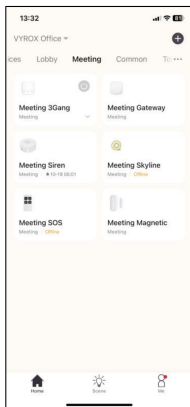

**Step 1: Add lighting switch into Tuya APP**  
Click "Gateway" at home page, click "Add subdevice" > "Lighting" > "Light Source (Zigbee)".

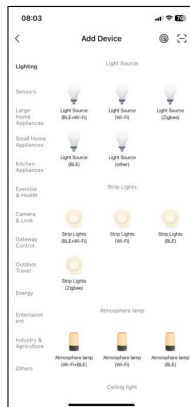
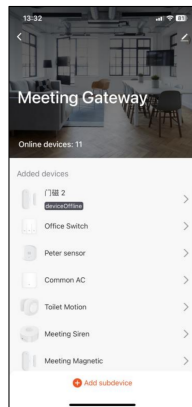

**Step 2: Pair lighting switch into Zigbee Gateway**  
First, switch on MCB for lighting switch. Press and hold first button of lighting switch until LED blinking.



**Step 3: Follow instruction**  
You are connecting a lighting switch to the Zigbee gateway. Repeat steps 1 to 2 if you cannot connect the device until it is successfully connected.

## 7. Add Door Sensor into Zigbee Gateway



## Add Door Sensor into Zigbee Gateway

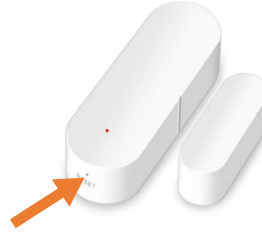
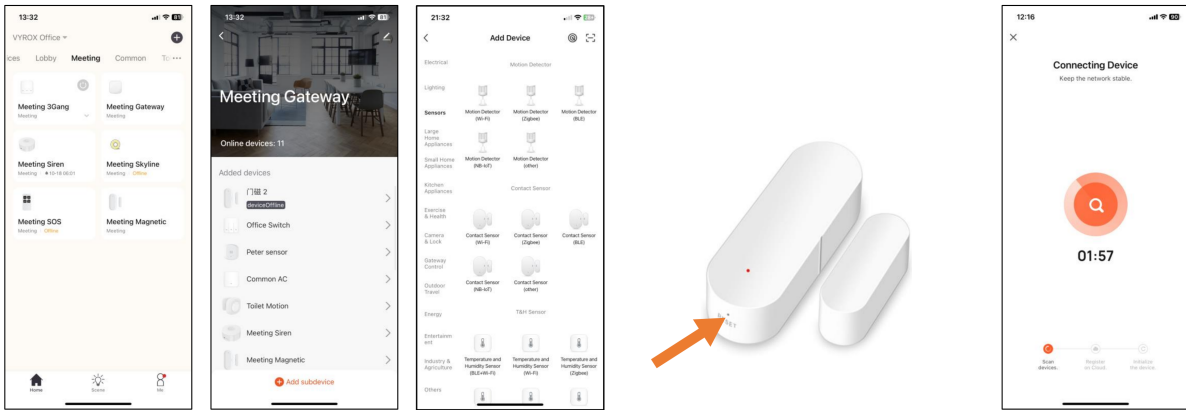

**Step 1: Add door sensor into Tuya APP**  
Select a "Gateway" at home page.  
Then, click "Add subdevice" > "Sensors" > "Contact Sensor (Zigbee)".

**Step 2: Pair door sensor into Zigbee Gateway**  
Power on the motion sensor.  
Press and hold the small button for 10 seconds until LED blinking.

**Step 3: Follow instruction**  
You are connecting a door sensor to the Zigbee gateway. Repeat steps 1 to 2 if you cannot connect the device until it is successfully connected.

## 8. Add SOS Button into Zigbee Gateway



## Add SOS Button into Zigbee Gateway

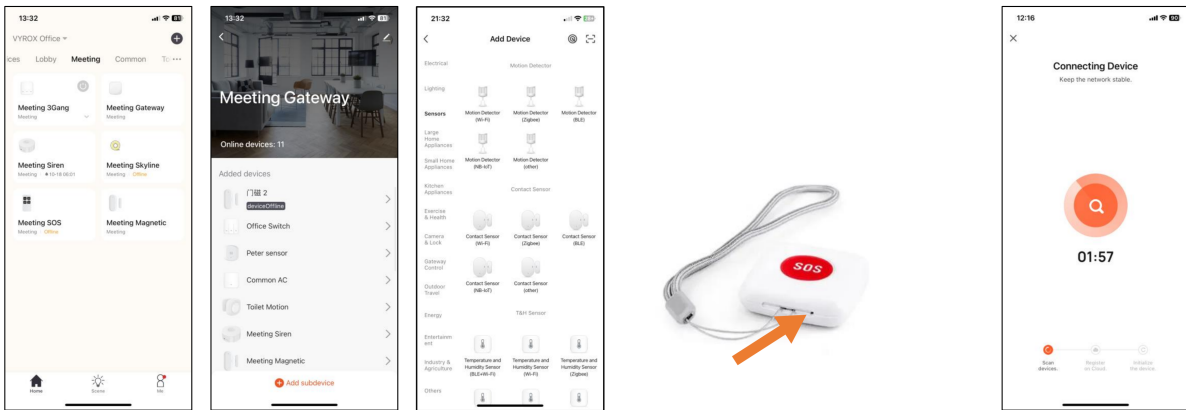

**Step 1: Add SOS button into Tuya APP**  
Select a "Gateway" at home page.  
Then, click "Add subdevice" > "Sensors" > "Emergency Button (Zigbee)".

**Step 2: Pair door sensor into Zigbee Gateway**  
Power on the SOS button.  
Press and hold the small button for 10 seconds until LED blinking.

**Step 3: Follow instruction**  
You are connecting a SOS button to the Zigbee gateway. Repeat steps 1 to 2 if you cannot connect the device until it is successfully connected.

## 9. Add Smart Intercom into Zigbee Gateway

## Add Smart Intercom Into Tuya APP

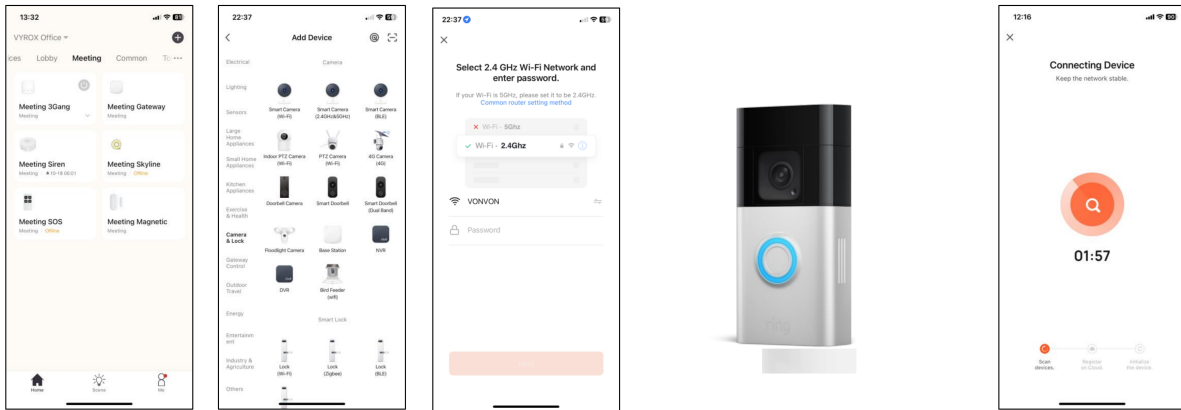

**Step 1: Add Smart Camera into Tuya APP**  
 Click "+" at home page, next, select "Add Device".  
 Then, select "Camera & Lock" > "Doorbell camera"  
 Then, Confirm the WiFi network and password.  
 Note: connect to 2.4GHz WiFi only.

**Step 2: Follow The Instruction**  
 The App will prompt you to scan a QR code that needs to be read by the smart camera to initiate pairing.

**Step 3: Confirm The Pairing**  
 Once you hear the sound prompt, confirm this on the App, this will commence the final stage of pairing the smart PTZ camera to your account.

## 10. Setup Google Home Voice Control To The VYROX AI Smart Mirror

### Pair Smart Home Devices with Google Home Nest For Voice Control

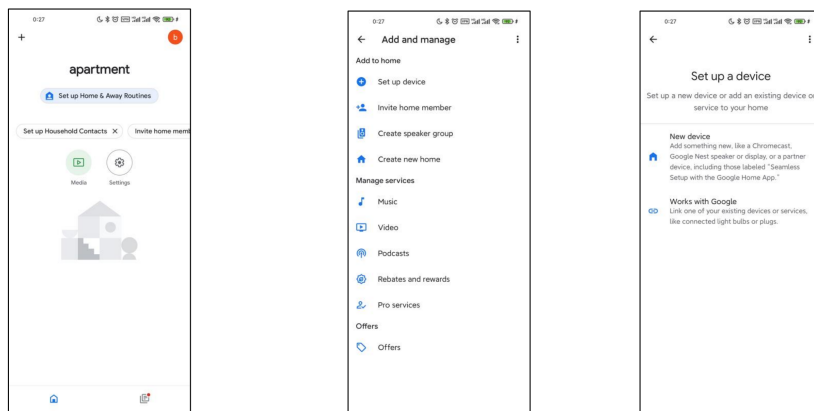

**Step 1: Download Google Home App**  
 Search "Google Home" at App Store: iOS Phone  
 Google Play Store: Android Phone  
 Then, download the Google Home App.

**Step 2: Login into Google Home App**  
 You must sign up and log in to the Google Home App with the same Gmail address that you use to log in to the Tuya Smart App.

**Step 3: Pair Tuya App into Google Home App**  
 Click "+" at left right corner.  
 Next click "Set up device",  
 Then click "Works with Google".

# Pair Smart Home Devices with Google Home Nest For Voice Control

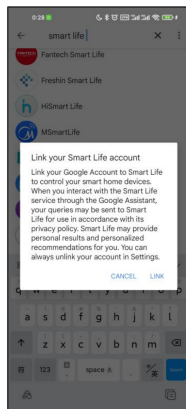

**Step 4: Link with "Tuya Smart"**  
Search "Tuya Smart", select "Tuya Smart" and click "Link".

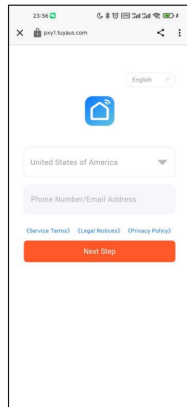

**Step 5: Log in to Tuya APP**  
Enter the same Gmail address and password that you used to sign up for the Tuya App.

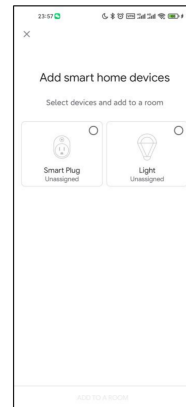

**Step 6: Tuya App Successfully Paired**  
When the Tuya App has been successfully paired with the Google Home App, you will be prompted to add smart home devices. Please tick all devices.

From:  
<https://www.vyrox.com/wiki/> - **VYROX Wiki**

Permanent link:  
[https://www.vyrox.com/wiki/doku.php?id=tuya\\_smart&rev=1740118877](https://www.vyrox.com/wiki/doku.php?id=tuya_smart&rev=1740118877)

Last update: **2025/02/21 06:21**

