

Smart Door Lock

7.1 Reset Smart Door Lock

- Press “Reset” button at rear door lock body
- When you hear the voice notification, press 000 # to restore factory settings.

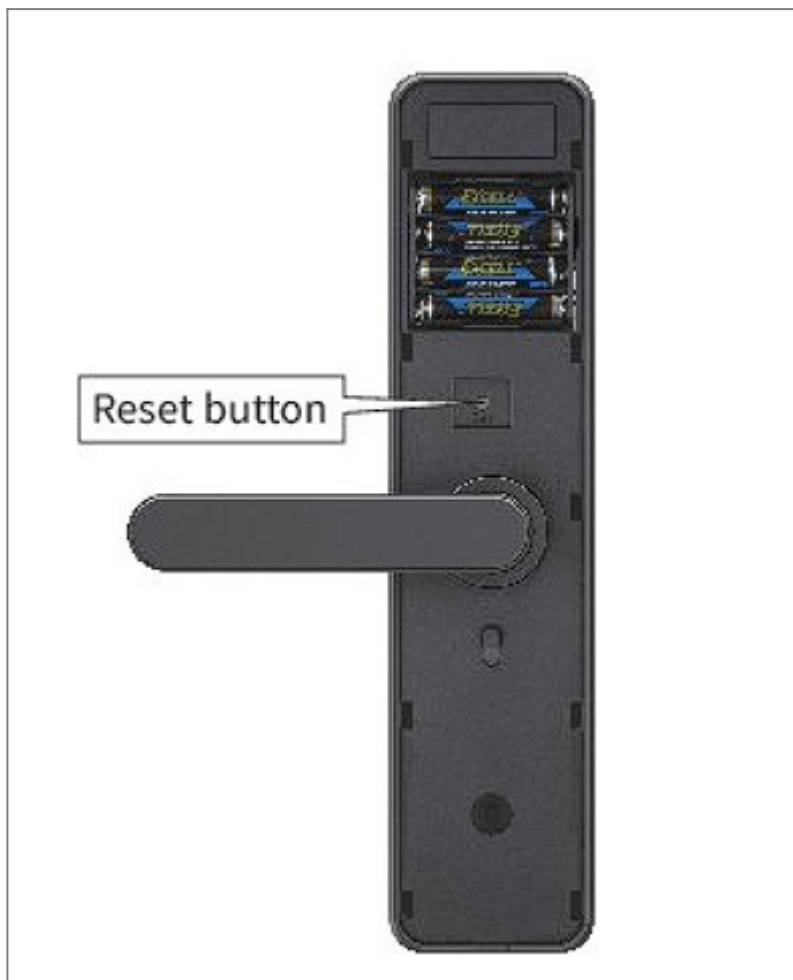

7.2 Change Language

- *39 # Admin Password #
- Press # 1, switch to Chinese.
- Press # 2, switch to English.

7.3 Reset Smart Door Lock and Change Admin Password (If You Forgot the Current Password)

- Press “Reset” button at rear door lock body
- Once you heard notification voice, press 000 # to factory reset the door lock.
- Press * 12 #.
- Listen to the voice prompt and enter default 6-digit password 123456 #.
- Listen to the voice prompt and enter a new 6-digit password xxxxxx #.
- Re-enter the new 6-digit password to confirm: xxxxxx #.
- Voice notification confirms the password change.

7.4 Change Admin Password (If You Know the Current Password)

- Press * 12 #.
- Listen to the voice prompt and enter current 6-digit admin password: xxxxxx #.
- Listen to the voice prompt and enter a new 6-digit password: xxxxxx #.
- Re-enter the new 6-digit password to confirm: xxxxxx #.
- Voice notification confirms the password change.

7.5 Add a Fingerprint

- Press * 80 #
- Listen to the voice prompt and enter current 6-digit admin password: xxxxxx #.
- Listen to the voice prompt and swipe your fingerprint on the handle.
- Swipe again
- Swipe one more time.
- Voice notification confirms successfully fingerprint registration.

7.6 Add a Physical RFID card

- Press * 80 #.
- Listen to the voice prompt and enter current 6-digit admin password: xxxxxx #.
- Listen to voice prompt, swipe the RFID card in front of the smart lock.
- Listen to voice prompt, swipe the RFID card again.
- Voice notification confirms the successfully card registration.

7.7 Unlocking with USB Emergency Power Supply and Physical Key

- If the battery is dead, connect a 5V power bank to the micro USB port at the bottom of the smart lock's front panel.
- Unlock using fingerprint, PIN code, or RFID card.
- Alternatively, use the mechanical key to unlock.

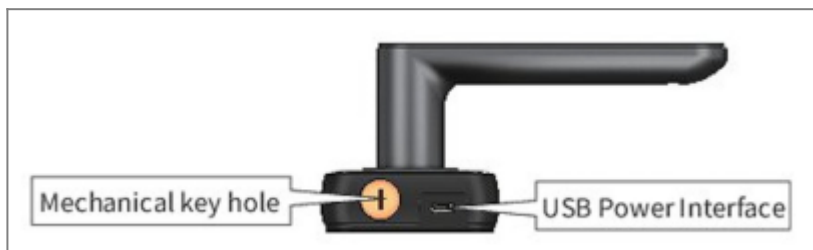

7.8 Advance Settings

Function	Actual Operation
1. Factory reset	Creates a brand-new visitor pass.
Consolidates all visitor tracking information into a single pass	Uses previous visitor details but starts fresh.
1. Factory reset	Creates a brand-new visitor pass.
1. Factory reset	Creates a brand-new visitor pass.
1. Factory reset	Creates a brand-new visitor pass.
1. Factory reset	Creates a brand-new visitor pass.

7.9 Smart Door Lock App Control

From:

<https://www.vyrox.com/wiki/> - **VYROX Wiki**

Permanent link:

https://www.vyrox.com/wiki/doku.php?id=smart_door_lock&rev=1740120364

Last update: **2025/02/21 06:46**

