

# Smart Door Lock

## 7.1 Reset Smart Door Lock

- Press “Reset” button at rear door lock body
- When you hear the voice notification, press 000 # to restore factory settings.

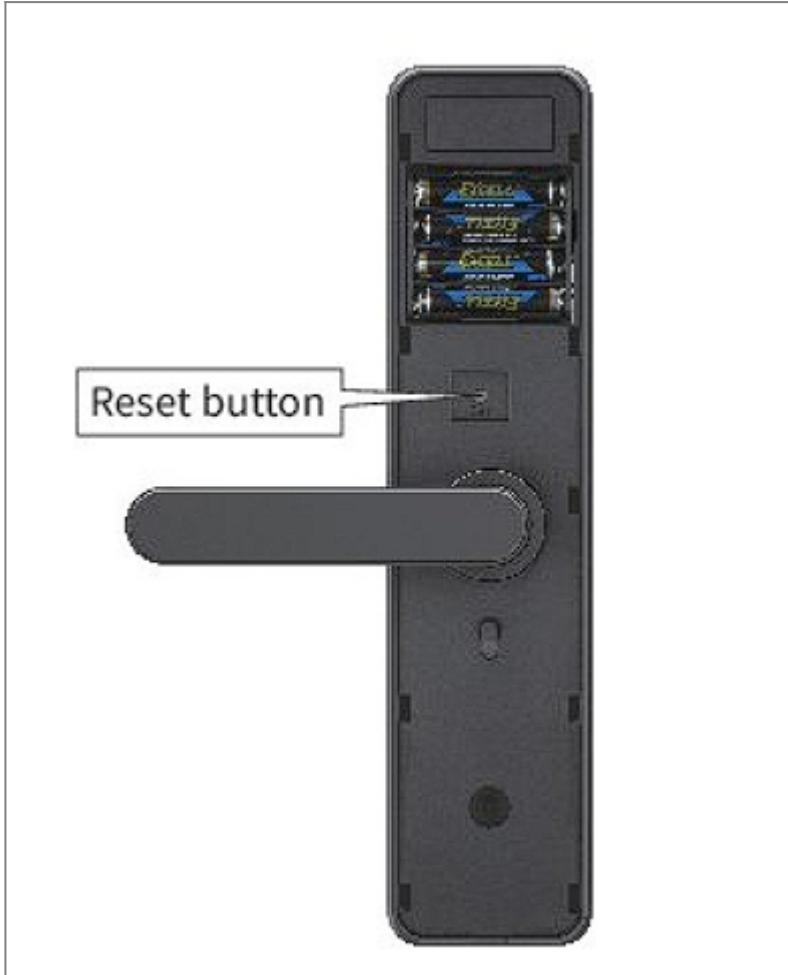

## 7.2 Change Language

- \*39 # Admin Password #
- Press # 1, switch to Chinese.
- Press # 2, switch to English.

## 7.3 Reset Smart Door Lock and Change Admin Password (If You Forgot the Current Password)

- Press “Reset” button at rear door lock body
- Once you heard notification voice, press 000 # to factory reset the door lock.
- Press \* 12 #.
- Listen to the voice prompt and enter default 6-digit password 123456 #.
- Listen to the voice prompt and enter a new 6-digit password xxxxxx #.
- Re-enter the new 6-digit password to confirm: xxxxxx #.
- Voice notification confirms the password change.

## 7.4 Change Admin Password (If You Know the Current Password)

- Press \* 12 #.
- Listen to the voice prompt and enter current 6-digit admin password: xxxxxx #.
- Listen to the voice prompt and enter a new 6-digit password: xxxxxx #.
- Re-enter the new 6-digit password to confirm: xxxxxx #.
- Voice notification confirms the password change.

### 7.5 Add a Fingerprint

- Press \* 80 #
- Listen to the voice prompt and enter current 6-digit admin password: xxxxxx #.
- Listen to the voice prompt and swipe your fingerprint on the handle.
- Swipe again
- Swipe one more time.
- Voice notification confirms successfully fingerprint registration.

### 7.6 Add a Physical RFID card

- Press \* 80 #.
- Listen to the voice prompt and enter current 6-digit admin password: xxxxxx #.
- Listen to voice prompt, swipe the RFID card in front of the smart lock.
- Listen to voice prompt, swipe the RFID card again.
- Voice notification confirms the successfully card registration.

### 7.7 Unlocking with USB Emergency Power Supply and Physical Key

- If the battery is dead, connect a 5V power bank to the micro USB port at the bottom of the smart lock's front panel.
- Unlock using fingerprint, PIN code, or RFID card.
- Alternatively, use the mechanical key to unlock.

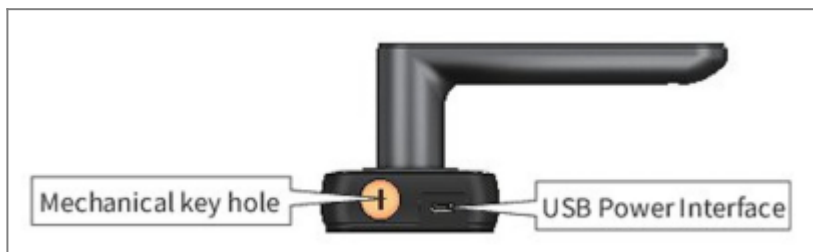

### 7.8 Advance Settings

### 7.9 Smart Door Lock App Control

From: <https://www.vyrox.com/wiki/> - **VYROX Wiki**

Permanent link: [https://www.vyrox.com/wiki/doku.php?id=smart\\_door\\_lock&rev=1740120230](https://www.vyrox.com/wiki/doku.php?id=smart_door_lock&rev=1740120230)

Last update: **2025/02/21 06:43**

